

vestre

Plinth

Table

Article no: 5632A&C, 5633A&C, 5634A&C

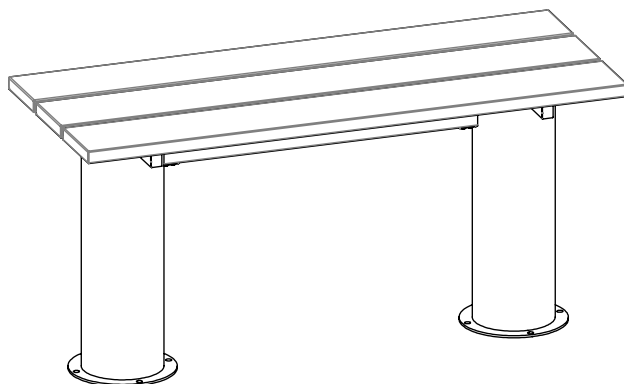
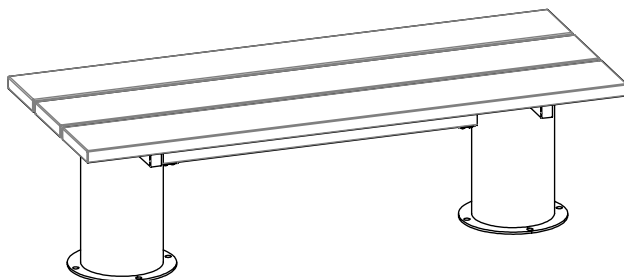
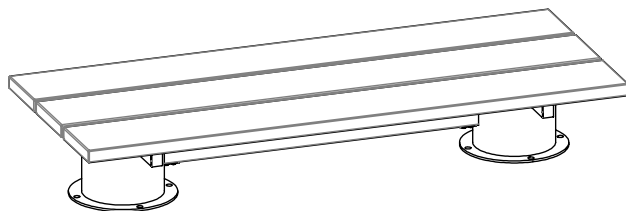

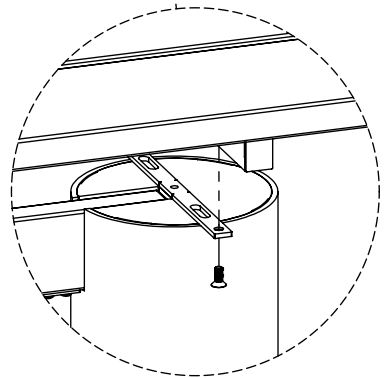
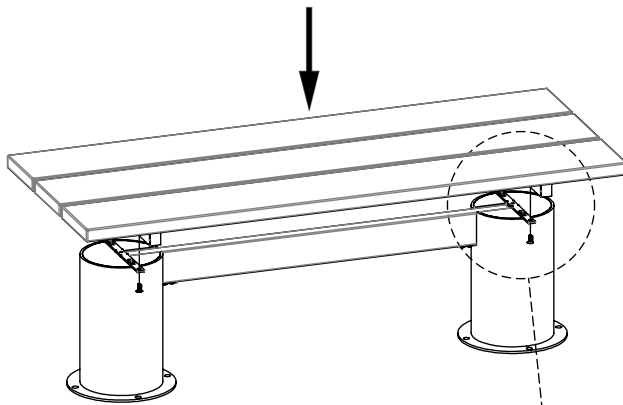
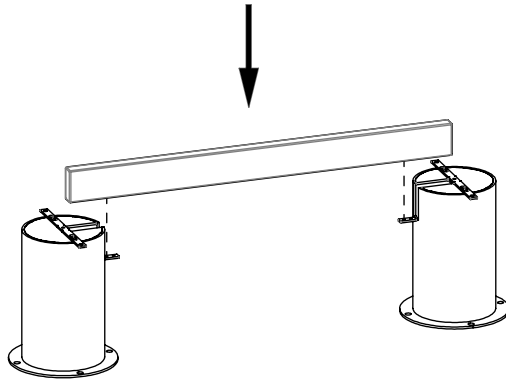

4x M8x20



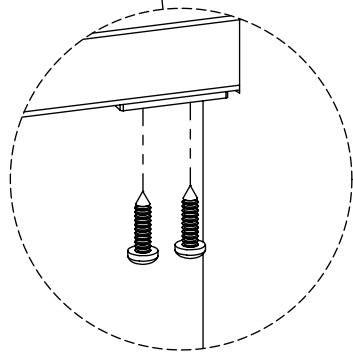
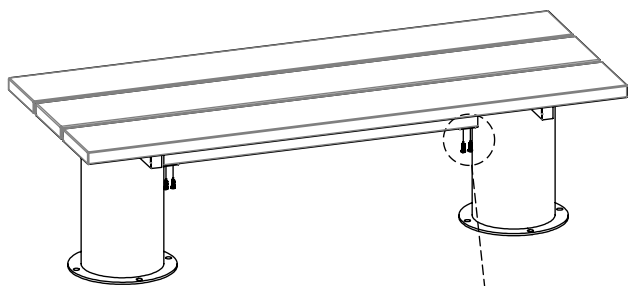

4x $\varnothing 6,3 \times 25$

Article no: 5632A - Baseplate

31 Kg

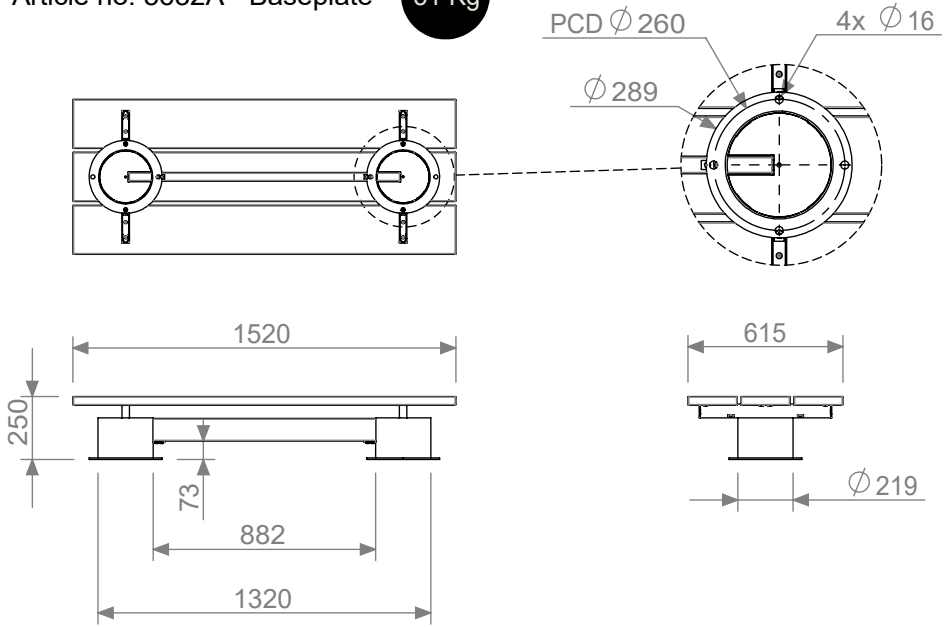

Article no: 5632C - Casting

52 Kg

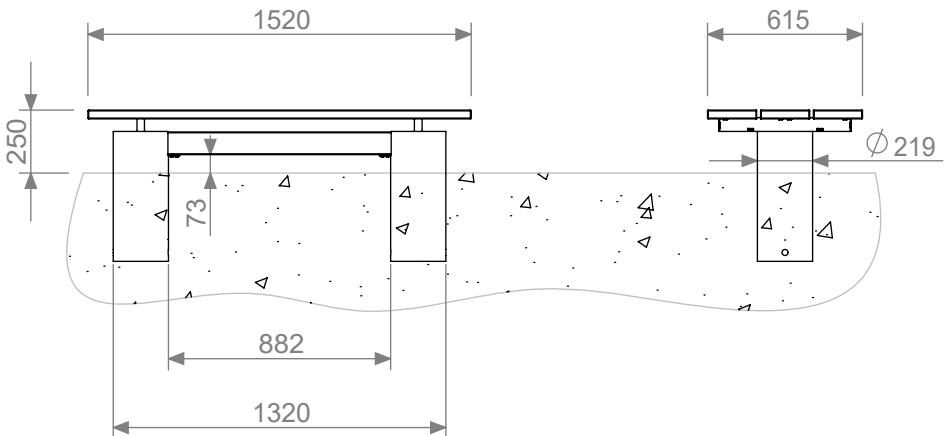

Article no: 5633A - Baseplate

44 Kg

PCD \varnothing 260

4x \varnothing 16

\varnothing 289

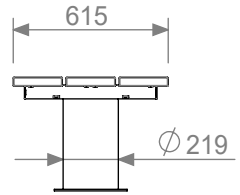
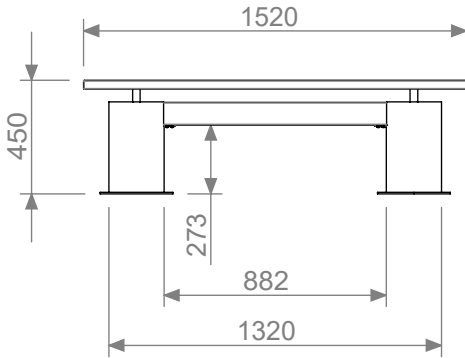
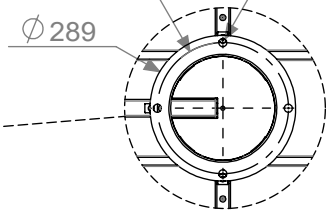
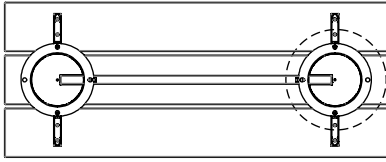

Article no: 5633C - Casting

65 Kg

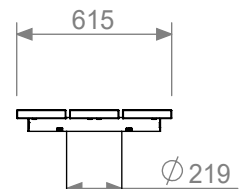
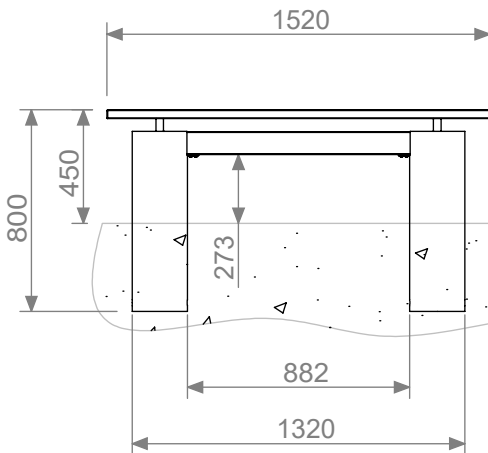

Article no: 5634A - Baseplate

63 Kg

PCD \varnothing 260

4x \varnothing 16

\varnothing 289

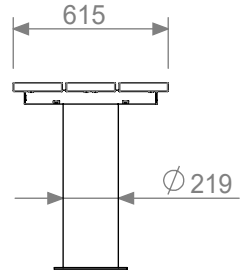
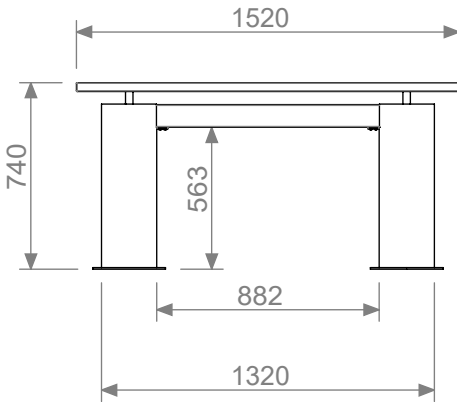
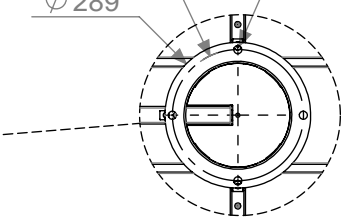
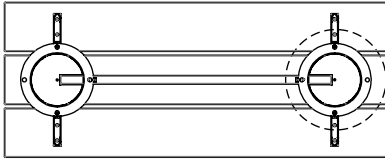

Article no: 5634C - Casting

84 Kg

